

AIR LINE REGULATORS

REMOTE CONTROL SERIES:- A119x20
SERVICE : COMPRESSED AIR

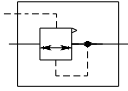

Application

Airmatic popular high capacity series 119 relieving type regulator is adapted for control by a remote or distant located small pilot regulator. Regulator is ruggedly constructed with extra large orifice and flow ports plus a balanced disc, for further description, see catalogue 012.

Ideal for continuous high capacity requirements where reduced pressure must be held constant over wide variations in flow. Constant bleed device provides exceptionally fine set point adjustment.

Technical Data

Material Specification

Body	Diecast Zinc / Aluminium
Diaphragm	Nylon, reinforced Nitrile
Disc / Seat	Brass
Spring / Pilot Dome	Aluminium
Valve Spring	St. Steel 304

Ordering References

SIZES	MODELS
G1/4	A119X20-02
G3/8	A119X20-03
G1/2	A119X20-04
G3/4	A119X20-06
G1	A119X20-08
G1.1/4	A119X20-10
G1.1/2	A119X20-12
G2	A119X20-16

For flow rates please refer catalogue data sheet no : 012

*Relieving Standard.

Typical Installation

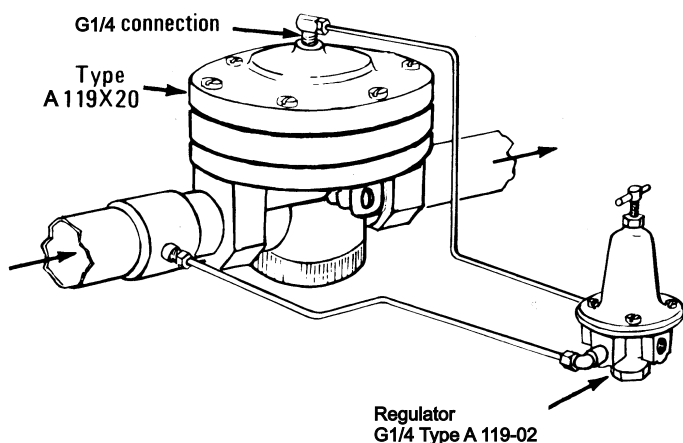

Condition of use

Max. Supply Pressure	12 Kg/cm ²
Max. Op. Temp.	70°C

Reduce Pressure Range

May be adjusted up to 90% of supply pressure

Service Kit

Relieving	SIZES			
	G1/4-G3/8-G1/2	G3/4-G1	G1.1/4-G1.1/2	G2
Service Kit	SPRA-O-R	SPRB-O-R	SPRC-O-R	SPRD-O-R

Accessories & Options

		SUFFIX
Pressure Gauge 55mm Dial G1/4 Back Connection	Range 0 to 2.1 Kg/cm ²	GB - 1
	0 to 4.2 Kg/cm ²	GB - 2
	0 to 10.6 Kg/cm ²	GB - 3

Model Ordering Code Instruction

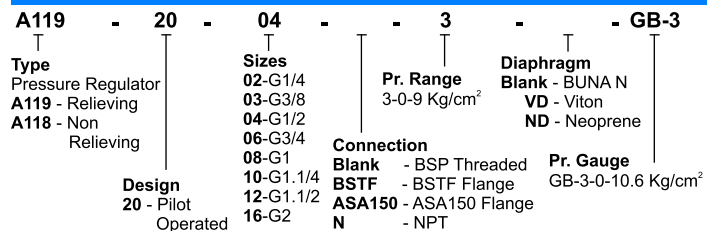

Dimensions & Weights

DIMENSIONS	SIZES			
	G1/4-G3/8-G1/2	G3/4-G1	G1.1/4-G1.1/2	G2
A	73	120	142	137
B	92	135	160	182
C	34	48	54	69
Wt. Kgs.	0.840	1.300	3.900	4.240

ALL DIMENSIONS ARE IN MM.

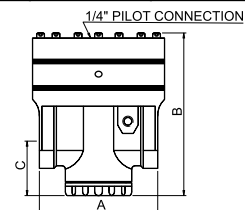

Shah Pneumatics

Regd. Office : 28-30, Navketan Industrial Estate,
 Mahakali Caves Road, Andheri (East),
 Mumbai - 400 093, INDIA.
 Phone : +91-22-6695 1090 Fax : +91-22-26875317
 E-mail : shahpneu@bom3.vsnl.net.in
 Website : www.shah-pneumatics.com

REMOTE CONTROL REGULATOR CAT.